

BNA-S31/-S32

09 / 02 BNA-ENG 02/1

Barksdale Bypass Level Indicators

Specifications are subject to changes without notice.

BNA-S31

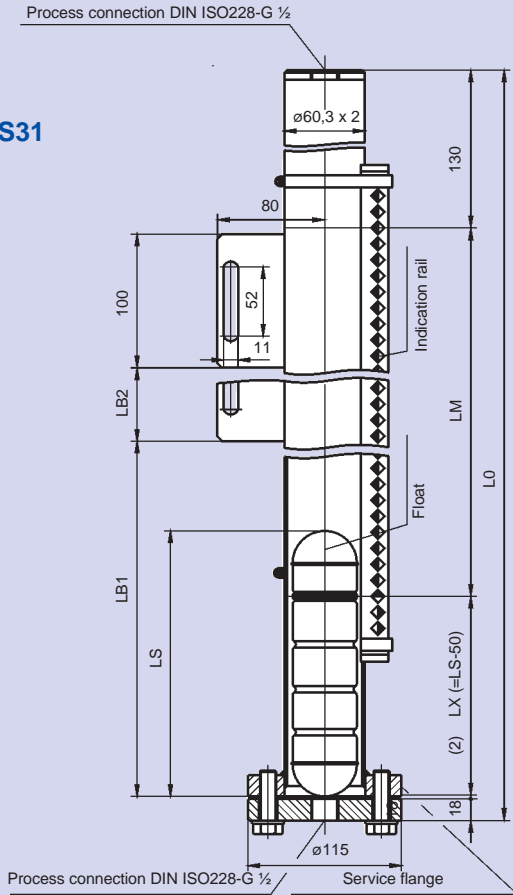

BNA-S32

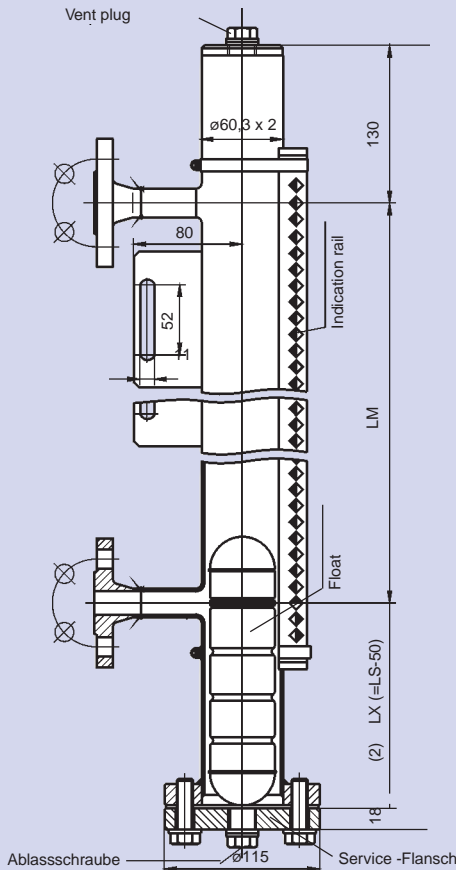

Technical Data

Standard Version:

Measuring range: L0 max. 6000 mm in one piece, max. LM in split sections on request

Bypass tube: Stainless Steel No. 1.4571 (SS 316 Ti)
PN 16, diameter 60,3 x 2 mm

Proof pressure: 1,5 x max. operating pressure

Process conn.: G 1/2 top and bottom with plug

Side connections: Threaded R 1/2, R 3/4, 1" or
DIN flanges DN 15, 25, 32, 40 oder 50, or
ASA DN 1/2", 3/4", 1", 1 1/4", 1 1/2"

Indication rail: Makrolon (Polycarbonate) with red and white square flags for medium temp. up to 150 °C

Float(s): Standard PN 25: VA 50/10 in 1.4571,
min. density: 0,62 g/cm³, max. temp. 150 °C

Type: Top G 1/2, bottom service-flange:
BNA-S31, top and bottom connections G 1/2
BNA-S32, side connections

Options:

Indication rail: Aluminum, black anodized,
square flags painted silver/red,
up to max. 350 °C –A2

Float(s): **VA 50/15** in 1.4571, with M4 plug,
min. density: 0,63 g/cm³, max. temp.: 150 °C

TT 50/10 in Titanium,
min. density: 0,56 g/cm³, max. temp.: 320 °C

TT 50/15 in Titanium, with M4 plug,
min. density: 0,57 g/cm³, max. temp. 320 °C

Connections: Instead of G 1/2 top and bottom, 1/2" NPT,
or flange connections with
weld neck flanges

Accessories:

- Limit switches
- Analog output
- Scale
- Isolation
- Tests / Certificates